

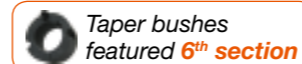

Moyeux amovibles  
présentés section 6



Taper bushes  
featured 6<sup>th</sup> section

STOCK AND PRICES  
ON ITAFRAN.COM

STOCK ET PRIX  
SUR ITAFRAN.COM

**CARACTERISTIQUES DIMENSIONNELLES**

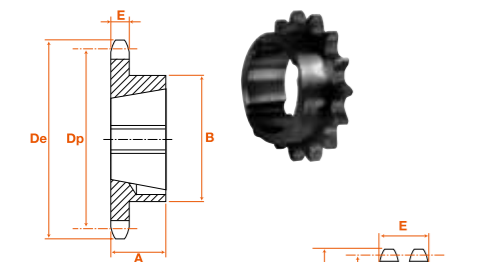

Type 1 : pignon acier simple denture avec moyeu déporté

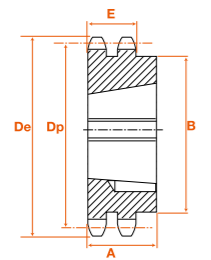

Type 2 : pignon acier double denture avec moyeu déporté

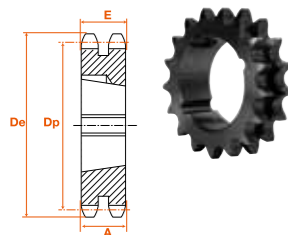

Type 3 : pignon acier double denture sans moyeu déporté

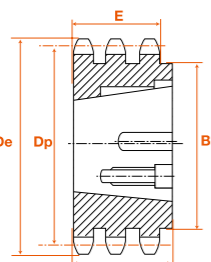

Type 4 : pignon acier triple denture avec moyeu déporté

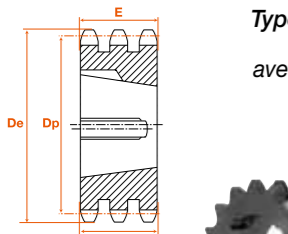

Type 5 : pignon acier triple denture sans moyeu déporté

**Côte E**

|                |         |
|----------------|---------|
| Simple denture | 9,1 mm  |
| Double denture | 25,5 mm |
| Triple denture | 42,1 mm |

| 10B - 5/8" x 3/8"                                |           |       |        |                 |       |   |      |       |      |
|--|-----------|-------|--------|-----------------|-------|---|------|-------|------|
| Chaîne largeur intérieure 9,65 - Ø rouleur 10,16 |           |       |        |                 |       |   |      |       |      |
| Dents  | Code      | De    | Dp     | Moyeu mini maxi | Type  | A | B    | Masse |      |
| <b>Simple</b>                                    |           |       |        |                 |       |   |      |       |      |
| 12   | PGS15812M | 68,0  | 61,34  | 1008            | 10/25 | 1 | 22   | 46    | 0,20 |
| 13   | PGS15813M | 73,0  | 66,32  | 1008            | 10/25 | 1 | 22   | 47    | 0,20 |
| 14   | PGS15814M | 78,0  | 71,34  | 1008            | 10/25 | 1 | 22   | 52    | 0,30 |
| 15   | PGS15815M | 83,0  | 76,36  | 1210            | 11/32 | 1 | 25   | 60    | 0,30 |
| 16   | PGS15816M | 88,0  | 81,37  | 1610            | 14/42 | 1 | 25   | 70    | 0,30 |
| 17   | PGS15817M | 93,0  | 86,36  | 1610            | 14/42 | 1 | 25   | 71    | 0,40 |
| 18   | PGS15818M | 98,3  | 91,42  | 1610            | 14/42 | 1 | 25   | 75    | 0,40 |
| 19   | PGS15819M | 103,3 | 96,45  | 1610            | 14/42 | 1 | 25   | 75    | 0,50 |
| 20   | PGS15820M | 108,4 | 101,49 | 1610            | 14/42 | 1 | 25   | 75    | 0,60 |
| 21   | PGS15821M | 113,4 | 106,52 | 1610            | 14/42 | 1 | 25   | 76    | 0,70 |
| 22   | PGS15822M | 118,0 | 111,55 | 1610            | 14/42 | 1 | 25   | 76    | 0,70 |
| 23   | PGS15823M | 123,4 | 116,58 | 1610            | 14/42 | 1 | 25   | 76    | 0,80 |
| 24   | PGS15824M | 128,3 | 121,62 | 2012            | 14/50 | 1 | 25   | 90    | 1,00 |
| 25   | PGS15825M | 134,0 | 126,66 | 2012            | 14/50 | 1 | 32   | 90    | 1,00 |
| 26   | PGS15826M | 139,0 | 131,70 | 2012            | 14/50 | 1 | 32   | 90    | 1,10 |
| 27   | PGS15827M | 144,0 | 136,75 | 2012            | 14/50 | 1 | 32   | 90    | 1,20 |
| 28   | PGS15828M | 148,7 | 141,78 | 2012            | 14/50 | 1 | 32   | 90    | 1,30 |
| 30   | PGS15830M | 158,8 | 151,87 | 2012            | 14/50 | 1 | 32   | 90    | 1,40 |
| 32   | PGS15832M | 168,9 | 161,95 | 2012            | 14/50 | 1 | --   | --    | 1,40 |
| 33   | PGS15833M | 174,5 | 167,00 | 2012            | 14/50 | 1 | --   | --    | 1,40 |
| 35   | PGS15835M | 184,1 | 177,10 | 2012            | 14/50 | 1 | --   | --    | 1,60 |
| 38   | PGS15838M | 199,2 | 192,24 | 2012            | 14/50 | 1 | 32   | 100   | 2,40 |
| 40   | PGS15840M | 209,3 | 202,34 | 2012            | 14/50 | 1 | --   | --    | 2,90 |
| 45   | PGS15845M | 235,0 | 227,58 | 2012            | 14/50 | 1 | 32   | 100   | 3,40 |
| 57   | PGS15857M | 296,0 | 288,18 | 2012            | 14/50 | 1 | 32   | 100   | 4,92 |
| <b>Double</b>                                    |           |       |        |                 |       |   |      |       |      |
| 13   | PGD15813M | 73,0  | 66,32  | 1008            | 10/25 | 3 | 25,5 | --    | 0,40 |
| 14   | PGD15814M | 78,0  | 71,34  | 1108            | 10/28 | 3 | 25,5 | --    | 0,40 |
| 15   | PGD15815M | 83,0  | 76,36  | 1210            | 11/32 | 3 | 25,5 | --    | 0,40 |
| 16   | PGD15816M | 88,0  | 81,37  | 1610            | 14/42 | 3 | 25,5 | --    | 1,00 |
| 17   | PGD15817M | 93,0  | 86,39  | 1610            | 14/42 | 3 | 25,5 | --    | 0,50 |
| 18   | PGD15818M | 98,3  | 91,42  | 1610            | 14/42 | 3 | 25,5 | --    | 0,60 |
| 19   | PGD15819M | 103,3 | 96,45  | 1610            | 14/42 | 3 | 25,5 | --    | 0,70 |
| 20   | PGD15820M | 108,4 | 101,49 | 1610            | 14/42 | 3 | 25,5 | --    | 0,90 |
| 21   | PGD15821M | 113,4 | 106,52 | 1610            | 14/42 | 3 | 25,5 | --    | 1,00 |
| 22   | PGD15822M | 118,0 | 111,55 | 1610            | 14/42 | 3 | 25,5 | --    | 1,20 |
| 23   | PGD15823M | 123,4 | 116,58 | 1610            | 14/42 | 3 | 25,5 | --    | 1,30 |
| 24   | PGD15824M | 128,3 | 121,62 | 2012            | 14/50 | 2 | 32   | 90    | 1,40 |
| 25   | PGD15825M | 134,0 | 126,66 | 2012            | 14/50 | 2 | 32   | 90    | 1,60 |
| 26   | PGD15826M | 139,0 | 131,70 | 2012            | 14/50 | 2 | 32   | 90    | 1,80 |
| 27   | PGD15827M | 144,0 | 136,75 | 2012            | 14/50 | 2 | 32   | 90    | 2,00 |
| 28   | PGD15828M | 148,7 | 141,78 | 2012            | 14/50 | 2 | 32   | 90    | 2,20 |
| 30   | PGD15830M | 158,8 | 151,87 | 2012            | 14/50 | 2 | 32   | 90    | 2,60 |
| 35   | PGD15835M | 184,1 | 177,10 | 2517            | 16/65 | 2 | 45   | 108   | 4,00 |
| 38   | PGD15838M | 199,2 | 192,24 | 2517            | 16/65 | 2 | 45   | 108   | 4,70 |
| 45   | PGD15845M | 235,0 | 227,58 | 2517            | 16/65 | 2 | 45   | 108   | 7,30 |
| <b>Triple</b>                                    |           |       |        |                 |       |   |      |       |      |
| 15   | PGT15815M | 83,0  | 76,36  | 1210            | 11/32 | 5 | 42,1 | --    | 0,60 |
| 17   | PGT15817M | 93,0  | 86,39  | 1610            | 14/42 | 5 | 42,1 | --    | 1,00 |
| 19   | PGT15819M | 103,3 | 96,45  | 1610            | 14/42 | 5 | 42,1 | --    | 1,20 |
| 21   | PGT15821M | 113,4 | 106,52 | 1615            | 14/50 | 5 | 42,1 | --    | 1,70 |
| 23   | PGT15823M | 123,4 | 116,58 | 2012            | 14/50 | 5 | 42,1 | --    | 1,80 |
| 25   | PGT15825M | 134,0 | 126,66 | 2517            | 16/65 | 4 | 45   | 105   | 1,80 |
| 27   | PGT15827M | 144,0 | 136,75 | 2517            | 16/65 | 4 | 45   | 110   | 2,50 |
| 30   | PGT15830M | 158,8 | 151,87 | 2517            | 16/65 | 4 | 45   | 120   | 3,50 |
| 38   | PGT15838M | 199,2 | 192,24 | 2517            | 16/65 | 4 | 45   | 120   | 6,90 |

| 12B - 3/4" x 7/16"                                |           |       |        |                 |       |   |      |       |       |
|---|-----------|-------|--------|-----------------|-------|---|------|-------|-------|
| Chaîne largeur intérieure 11,68 - Ø rouleur 12,07 |           |       |        |                 |       |   |      |       |       |
| Dents   | Code      | De    | Dp     | Moyeu mini maxi | Type  | A | B    | Masse |       |
| <b>Simple</b>                                     |           |       |        |                 |       |   |      |       |       |
| 11  | PGS19011M | 75,0  | 67,61  | 1008            | 10/25 | 1 | 22   | 46    | 0,3   |
| 12  | PGS19012M | 81,5  | 73,61  | 1008            | 10/28 | 1 | 22   | 52    | 0,3   |
| 13  | PGS19013M | 87,5  | 79,59  | 1210            | 11/32 | 1 | 25   | 60    | 0,3   |
| 14  | PGS19014M | 93,6  | 85,61  | 1610            | 14/42 | 1 | 25   | 70    | 0,4   |
| 15  | PGS19015M | 99,8  | 91,63  | 1610            | 14/42 | 1 | 25   | 70    | 0,4   |
| 16  | PGS19016M | 105,5 | 97,65  | 1610            | 14/42 | 1 | 25   | 75    | 0,6   |
| 17  | PGS19017M | 111,5 | 103,67 | 1610            | 14/42 | 1 | 25   | 76    | 0,7   |
| 18  | PGS19018M | 118,0 | 109,71 | 2012            | 14/50 | 1 | 32   | 90    | 0,8   |
| 19  | PGS19019M | 124,2 | 115,75 | 2012            | 14/50 | 1 | 32   | 90    | 1,0   |
| 20  | PGS19020M | 129,7 | 121,78 | 2012            | 14/50 | 1 | 32   | 90    | 1,0   |
| 21  | PGS19021M | 136,0 | 127,82 | 2517            | 16/65 | 1 | 45   | 102   | 1,2   |
| 22  | PGS19022M | 141,8 | 133,86 | 2517            | 16/65 | 1 | 45   | 102   | 1,4   |
| 23  | PGS19023M | 149,0 | 139,9  | 2517            | 16/65 | 1 | 45   | 108   | 1,7   |
| 24  | PGS19024M | 153,9 | 145,94 | 2517            | 16/65 | 1 | 45   | 108   | 1,8   |
| 25  | PGS19025M | 160,0 | 152    | 2517            | 16/65 | 1 | 45   | 108   | 1,9   |
| 26  | PGS19026M | 165,9 | 158,04 | 2517            | 16/65 | 1 | 45   | 108   | 2,1   |
| 27  | PGS19027M | 172,3 | 164    | 2517            | 16/65 | 1 | 45   | 108   | 2,2   |
| 28  | PGS19028M | 178,0 | 170,13 | 2517            | 16/65 | 1 | 45   | 108   | 2,3   |
| 30  | PGS19030M | 190,5 | 182,25 | 2517            | 16/65 | 1 | 45   | 108   | 2,6   |
| 38  | PGS19038M | 239,0 | 230,69 | 2517            | 16/65 | 1 | 45   | 108   | 3,9   |
| 45  | PGS19045M | 282,5 | 273,1  | 2517            | 16/65 | 1 | 45   | 108   | 6,0   |
| 57  | PGS19057M | 355,4 | 345,81 | 2517            | 16/65 | 1 | 45   | 108   | 9,2   |
| <b>Double</b>                                     |           |       |        |                 |       |   |      |       |       |
| 13  | PGD19013M | 87,5  | 79,59  | 1210            | 11/32 | 3 | 30   | --    | 0,50  |
| 14  | PGD19014M | 93,6  | 85,61  | 1610            | 14/42 | 3 | 30   | --    | 0,60  |
| 15  | PGD19015M | 99,8  | 91,63  | 1610            | 14/42 | 3 | 30   | --    | 0,70  |
| 16  | PGD19016M | 105,5 | 97,65  | 1610            | 14/42 | 3 | 30   | --    | 0,90  |
| 17  | PGD19017M | 111,5 | 103,67 | 1610            | 14/42 | 3 | 30   | --    | 1,20  |
| 18  | PGD19018M | 118,0 | 109,71 | 2012            | 14/50 | 2 | 32   | 90    | 1,00  |
| 19  | PGD19019M | 124,2 | 115,75 | 2012            | 14/50 | 2 | 32   | 90    | 1,30  |
| 20  | PGD19020M | 129,7 | 121,78 | 2517            | 16/65 | 2 | 45   | 108   | 1,40  |
| 21  | PGD19021M | 136,0 | 127,82 | 2517            | 16/65 | 2 | 45   | 108   | 1,60  |
| 22  | PGD19022M | 141,8 | 133,86 | 2517            | 16/65 | 2 | 45   | 108   | 2,00  |
| 23  | PGD19023M | 149,0 | 139,90 | 2517            | 16/65 | 2 | 45   | 108   | 2,20  |
| 24  | PGD19024M | 153,9 | 145,94 | 2517            | 16/65 | 2 | 45   | 108   | 2,60  |
| 25  | PGD19025M | 160,0 | 152,00 | 2517            | 16/65 | 2 | 45   | 108   | 2,90  |
| 26  | PGD19026M | 165,9 | 158,04 | 2517            | 16/65 | 2 | 45   | 108   | 3,20  |
| 27  | PGD19027M | 172,3 | 164,09 | 2517            | 16/65 | 2 | 45   | 108   | 3,60  |
| 28  | PGD19028M | 178,0 | 170,13 | 2517            | 16/65 | 2 | 45   | 108   | 3,90  |
| 30  | PGD19030M | 190,5 | 182,25 | 2517            | 16/65 | 2 | 45   | 108   | 4,70  |
| 38  | PGD19038M | 239,0 | 230,69 | 3020            | 25/75 | 2 | 51   | 140   | 8,60  |
| 45  | PGD19045M | 282,5 | 273,10 | 3020            | 25/75 | 2 | 51   | 140   | 11,75 |
| <b>Triple</b>                                     |           |       |        |                 |       |   |      |       |       |
| 15  | PGT19015M | 99,8  | 91,63  | 1615            | 14/42 | 5 | 49,8 | --    | 1,10  |
| 17  | PGT19017M | 111,5 | 103,67 | 1615            | 14/50 | 5 | 49,8 | --    | 1,30  |
| 19  | PGT19019M | 124,2 | 115,75 | 2012            | 14/50 | 5 | 49,8 | --    | 2,00  |
| 21  | PGT19021M | 136,0 | 127,82 | 2517            | 16/65 | 5 | 49,8 | --    | 2,00  |
| 23  | PGT19023M | 149,0 | 139,90 | 2517            | 16/65 | 5 | 49,8 | --    | 3,00  |
| 25  | PGT19025M | 160,0 | 152,00 | 2517            | 16/65 | 5 | 49,8 | --    | 4,00  |
| 27  | PGT19027M | 172,3 | 164,09 | 3020            | 25/75 | 4 | 51   | 140   | 3,90  |
| 30  | PGT19030M | 190,5 | 182,25 | 3020            | 25/75 | 4 | 51   | 140   | 5,70  |
| 38  | PGT19038M | 239,0 | 230,69 | 3020            | 25/75 | 4 | 51   | 140   | 12,50 |
| 45  | PGT19045M | 282,5 | 273,10 | 3020            | 25/75 | 4 | 51   | 140   | 18,00 |

**CARACTERISTIQUES DIMENSIONNELLES**

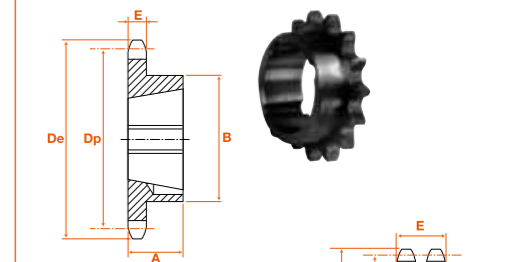

Type 1 : pignon acier simple denture avec moyeu déporté

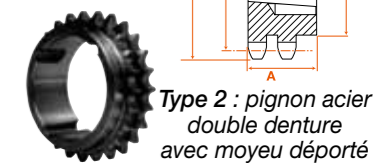

Type 2 : pignon acier double denture avec moyeu déporté

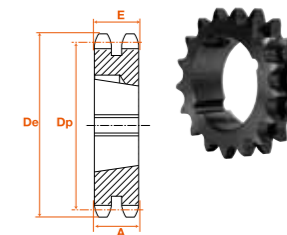

Type 3 : pignon acier double denture sans moyeu déporté

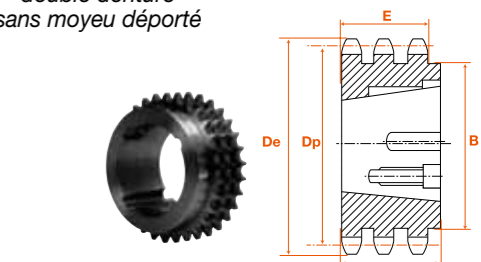

Type 4 : pignon acier triple denture avec moyeu déporté

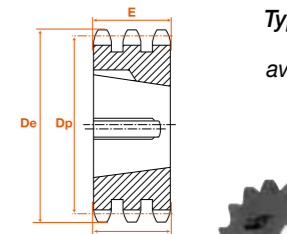

Type 5 : pignon acier triple denture sans moyeu déporté

**Côte E**